

GROUND FLOOR PLAN

SCALE: 1:100
 1. ALL SLAB THICKNESS = 125MM THK. U.N.O
 2. SECTION A-A, B-B, C-C, D-D, E-E AND F-F REFER DRAWING NO: MA0221/IMPIAN/A6-01/DSC/SD/01.

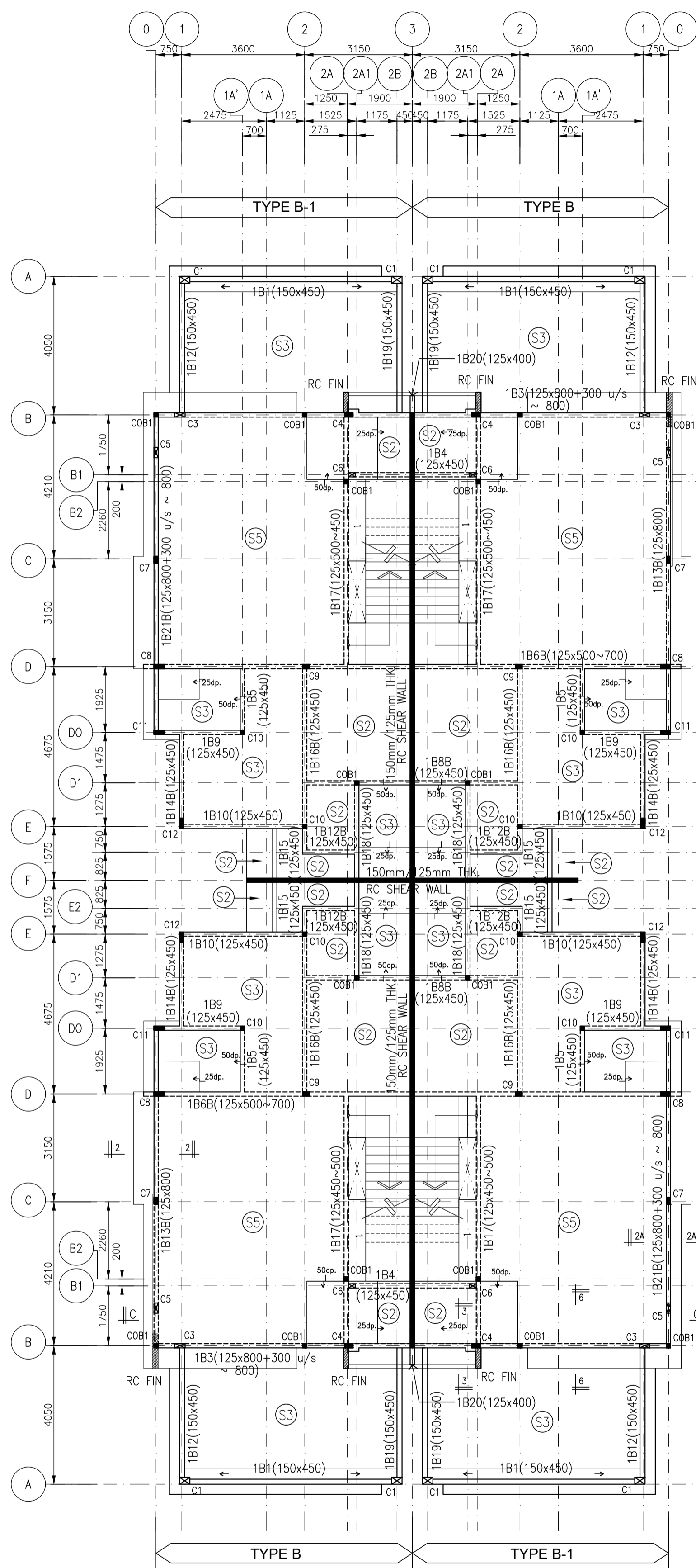

FIRST FLOOR PLAN

SCALE: 1:100
 ALL SLAB THICKNESS = 125MM THK. U.N.O

NOTES:

- THIS DRAWING IS TO BE READ IN CONJUNCTION WITH ARCHITECTURAL DRAWINGS AND OTHER RELEVANT DRAWINGS.
- ALL THE DIMENSIONS SHOULD BE RECONCILE WITH THE ARCHITECTURAL DRAWINGS.
- ALL THE DIMENSIONS ARE IN MILLIMETERS UNLESS OTHERWISE STATED.
- CONCRETE SHALL BE GRADE 25 WITH AGGREGATE OF MAXIMUM SIZE OF 20mm .
- PORTLAND CEMENT SHALL COMPLY TO BS 12.
- COARSE AND FINE AGGREGATE SHALL COMPLY TO BS 882.
- REINFORCEMENT TYPES ARE INDICATED AS :
 R : MILD STEEL PLAIN ROUND BARS TO BS 4449 WITH MINIMUM STRENGTH OF 250 N/mm.sq.
 T : HIGH TENSILE ROUND DEFORMED BARS TO BS 4449 WITH MINIMUM STRENGTH OF 460 N/mm.sq.
- WHERE BAR SPACING ARE NOT SHOWN THEY SHALL BE TAKEN AS BEING EQUAL.
- MINIMUM LAP LENGTH SHALL BE 40 DIA. UNLESS OTHERWISE STATED.
- STRUCTURAL FLOOR LEVEL (SFL) SHALL BE 50mm BELOW FINISH FLOOR LEVEL (FFL).
- ANTI TERMITE AND WATER PROOFING TO BE DONE BEFORE CONCRETING OF GROUND FLOOR BEAMS, SLABS AND FOUNDATION.
- R.C COPING LOCATION TO REFER ARCHITECT DRAWINGS.
- R.C COPING DETAILS TO REFER GENERAL NOTES & MISCELLANEOUS DWG.
- ROOF TRUSS DESIGN AND FABRICATION IS UNDER PROPRIETARY SYSTEM.
- THE PROPRIETOR'S ROOF TRUSS DESIGN CALCULATION REPORTS AND DRAWINGS WITH P.E. ENDORSEMENT SHALL BE SUBMITTED TO STRUCTURAL ENGINEER (MAJID & ASSOCIATES SDN. BHD.) FOR REVIEW PRIOR TO FABRICATION AT FACTORY.
- WALL PLATES MUST BE PROVIDED AND FIXED ON TOP OF ROOF BEAM BY CAST-IN DOWEL STEEL BARS T10-300 c/c ALONG THE ROOF BEAMS FOR SUPPORTING ROOF TRUSSES.

SLAB PANEL REFERENCE	SLAB THICKNESS (mm)	TOP REINFORCEMENT WIRE MESH	BOTTOM REINFORCEMENT WIRE MESH	REMARKS
(S1)	125	BRC A7	BRC A7	-
(S2)	125	BRC A7	BRC A7	2-WAY SLAB
(S3)	150	BRC A8	BRC A8	2-WAY SLAB
(S4)	175	BRC A8	BRC A8	2-WAY SLAB
(S5)	200	BRC A10	BRC A10	2-WAY SLAB

SLAB REINFORCEMENT SCHEDULE

SCALE : N.T.S

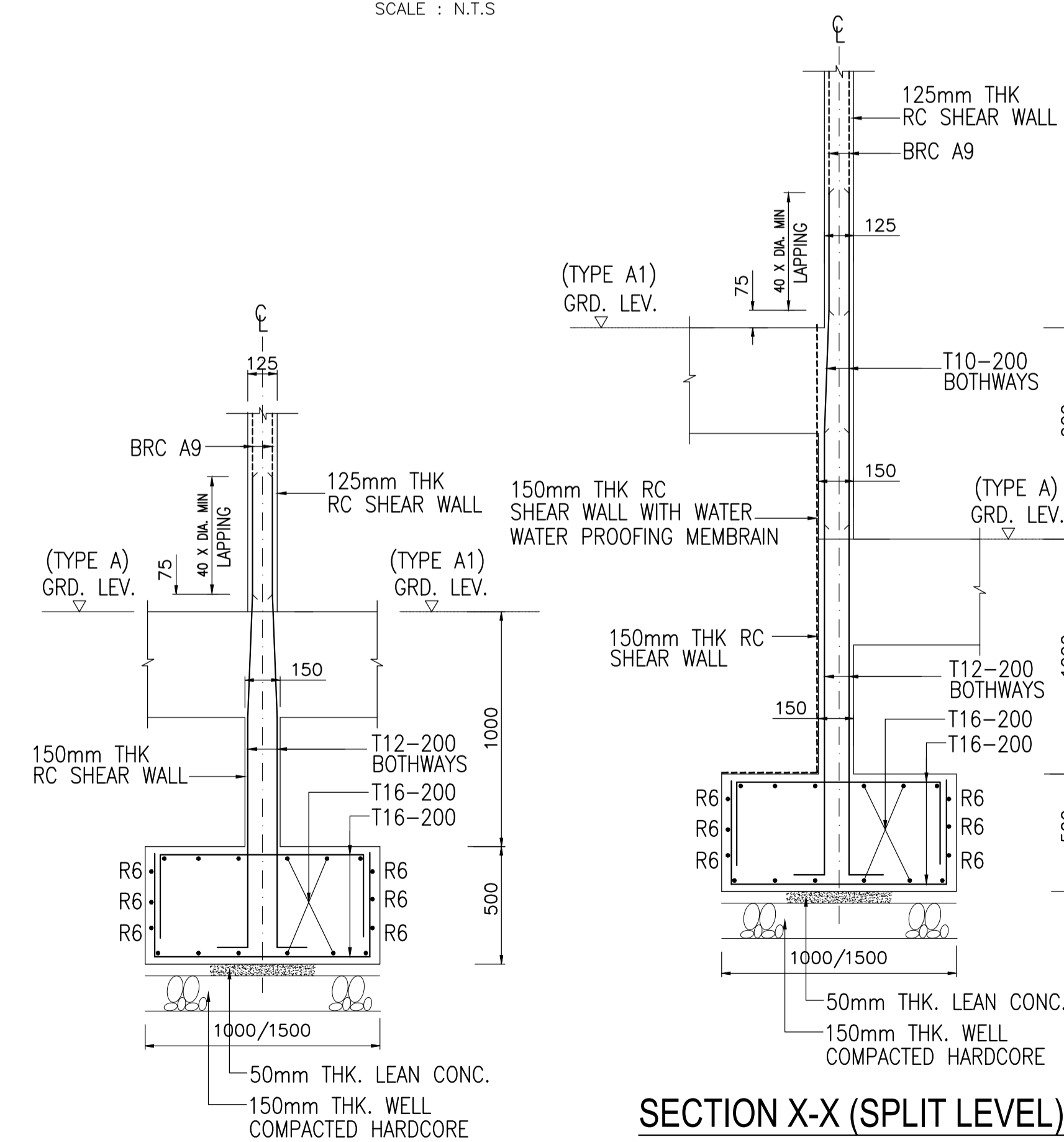

SECTION X-X (SPLIT LEVEL)

SCALE 1:20

SECTION Y-Y

SCALE 1:20

CATATAN:

CONSTRUCTION DRAWING
OGOS 2022

TAJUK CADANGAN :

[ALAM IMPIAN-64 UNIT DOUBLE STOREY CLUSTER HOUSE (35'x70') PHASE A6-01 (CASABLANCA 2) & 1 UNIT TNB SUBSTATION (SINGLE CHAMBER) AT PRECINCT 6]

CADANGAN MEMBINA DAN MENYIAPKAN 64 UNIT RUMAH KLUSTER 2 TINGKAT (35'x70') YANG MENDUNGKI JENIS A (20 UNIT), JENIS A-1 (20 UNIT), JENIS B (12 UNIT) DAN JENIS B-1 (12 UNIT) DI ATAS LOT PT 157194 - LOT 157257, BESERTA SEBUAH PENCAWANG ELEKTRIK (SINGLE CHAMBER) DI ATAS LOT PT 149555, FASA A6-01, PRECINCT 6, ALAM IMPIAN, SEKSYEN 35, 40470 SHAH ALAM, SELANGOR DARUL EHSAN UNTUK TETUAN I&P ALAM IMPIAN SDN. BHD

PEMILIK :

I & P
 Member of
Setia
 DATUK ZAINI BIN YUSOFF
 EXECUTIVE VICE PRESIDENT
 641211-02-5045
 I&P ALAM IMPIAN SDN. BHD.
 (Company No. 384248M)
 EIGHT KINRARA - BLOCK B, JALAN BK 5A/1,
 BANDAR KINRARA, 47180 PUCHONG,
 SELANGOR DARUL EHSAN
 TEL : +603-8082 9600 FAX: +603-4259 7500

JURUTERA BERDAFTAR :

MAJID & ASSOCIATES SDN. BHD.
 CIVIL AND STRUCTURAL CONSULTING ENGINEERS
 5B, JLN. BOLA JARING 1315
 SEKSYEN 13,
 40000 SHAH ALAM
 SELANGOR DARUL EHSAN.
 TEL : 03-55195958
 TELEFAX : 03-55139638
 EMAIL : masbons@gmail.com

IR. ABDADHIR A. MAJID
 JURUTERA PERENCANA MALAYSIA (CI 4104)
 I HEREBY CERTIFY THAT THESE WORKS HAVE BEEN DESIGNED BY ME IN ACCORDANCE WITH SOUND ENGINEERING PRACTICE AND THAT I TAKE FULL RESPONSIBILITY FOR THE DESIGN, AND PROPER PERFORMANCE OF THE SAME.

© ALL RIGHTS RESERVED. ALL DRAWINGS COPYRIGHT BY MAJID & ASSOCIATES SDN. BHD. AND MAY NOT BE REPRODUCED BY ANY MEANS WITHOUT PRIOR WRITTEN PERMISSION OF MAJID & ASSOCIATES SDN. BHD. © 2022.

PROJEK NO. : MA0221	DILUKIS : ZAM
SKALA : 1 : 100	DIREKA : MIMI/FARAH
TARIKH : OGOS 2022	DISEMAK : MIMI
SAIZ : A1	DILULUSKAN : TSA/RIDZ

NO.	PERKARA	TARIKH

TAJUK LUKISAN :

TYPE B & B-1
GROUND FLOOR BEAM & FIRST FLOOR
BEAM LAYOUT PLAN

NO. LUKISAN : PINDAAN :

MA0221/IMPIAN/A6-01/DSC/B&B-1/LP/01 **0**